

Tool # 1

OD Front Turning Tool -- Roughing

Negative Rake Common Hardware

MCLNR/L 95° Lead Turning and Facing

80° Diamond Insert
Use Insert Style CNxx

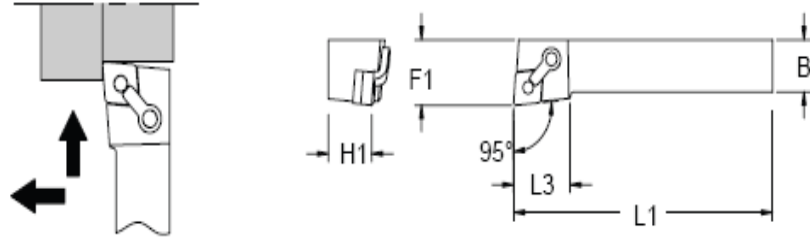

Right-hand shown, Left-hand opposite.

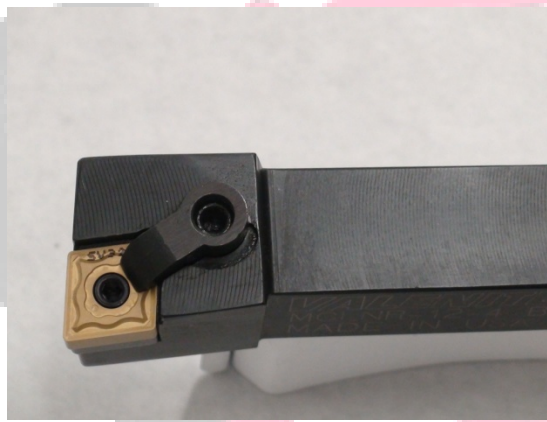

Part Number	Dimensions							
	Insert Size	B	H1	F1	L1	L3	Axial	Radial
MCLNR/L 12-4B	432	0.75	0.75	1	4.5	1.19	-5°	-5°



Tool # 2

OD Front Turning Tool – Semi-Finishing

Negative Rake Common Hardware

MDJNR/L 93° Lead Turning and Profiling

55° Diamond Insert
Use Insert Style WNxx

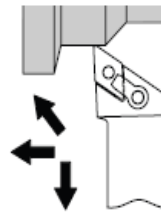
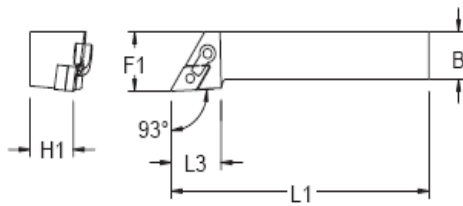

Right-hand shown, Left-hand opposite.

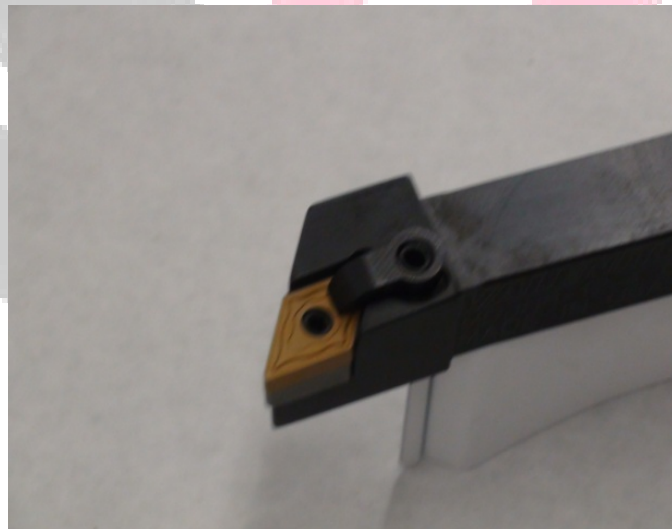

Part Number	Dimensions							
	Insert Size	B	H1	F1	L1	L3	Axial	Radial
MDJNR 12-4B	432	0.75	0.75	1	4.5	0.42	-5°	-5°

Tool # 3

OD Front Turning Tool – Finishing

Negative Rake Common Hardware

MVJNR/L 93° Lead Turning and Profiling

35° Diamond Insert
Use Insert Style VNxx

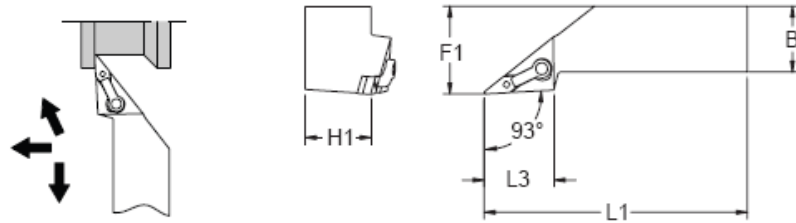

Right-hand shown, Left-hand opposite.

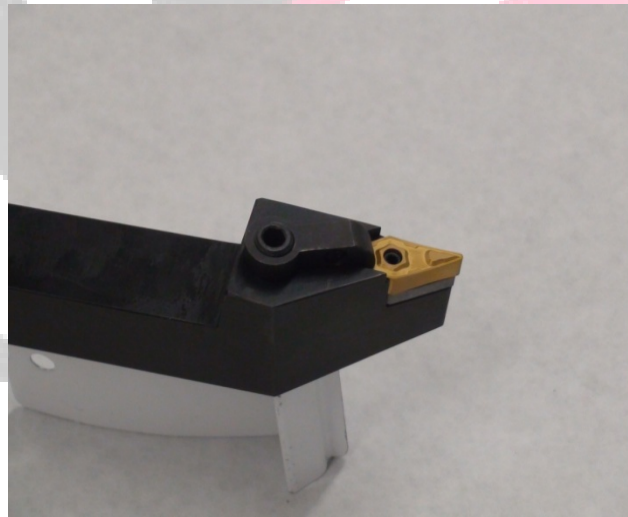

Part Number	Dimensions							
	Insert Size	B	H1	F1	L1	L3	Axial	Radial
MVJNR 12-3B	332	0.75	0.75	1	4.5	1.73	-10°	-4°



Tool #4

External Threading Tool

SEL 0750 K16

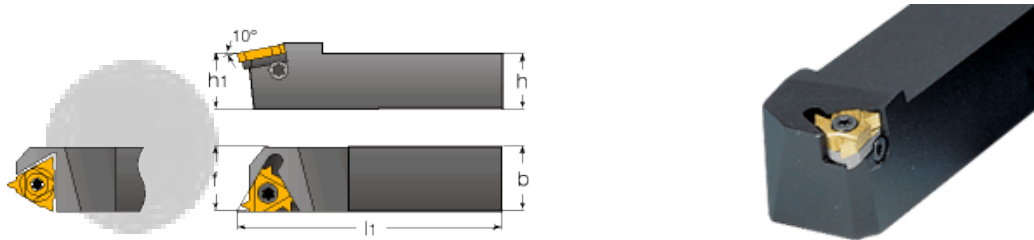

Part Number	Dimensions				
	h	h1	b	l1	f
SEL 0750 K16	20	20	20	125	20



Tool # 5

OD Back Turning Tool – Semi-Finishing

Negative Rake Common Hardware

MDJNR/L 93° Lead Turning and Profiling

55° Diamond Insert
Use Insert Style WNxx

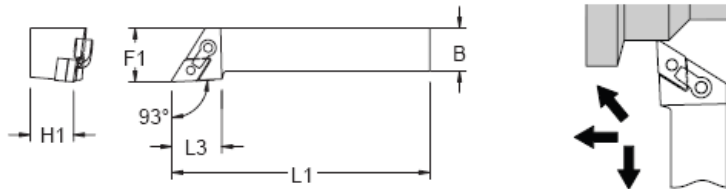

Right-hand shown, Left-hand opposite.



Part Number	Dimensions							
	Insert Size	B	H1	F1	L1	L3	Axial	Radial
MDJNL 12-4B	432	0.75	0.75	1	4.5	0.42	-5°	-5°



Tool # 6

OD Front Turning Tool – Finishing

Negative Rake Common Hardware

MVJNR/L 93° Lead Turning and Profiling

35° Diamond Insert
Use Insert Style VNxx

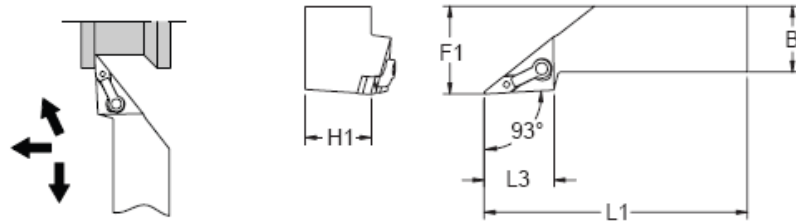

Right-hand shown, Left-hand opposite.



Part Number	Dimensions							
	Insert Size	B	H1	F1	L1	L3	Axial	Radial
MVJN L 12-3B	332	0.75	0.75	1	4.5	1.73	-10°	-4°



Tool # 7

OD Grooving Tool

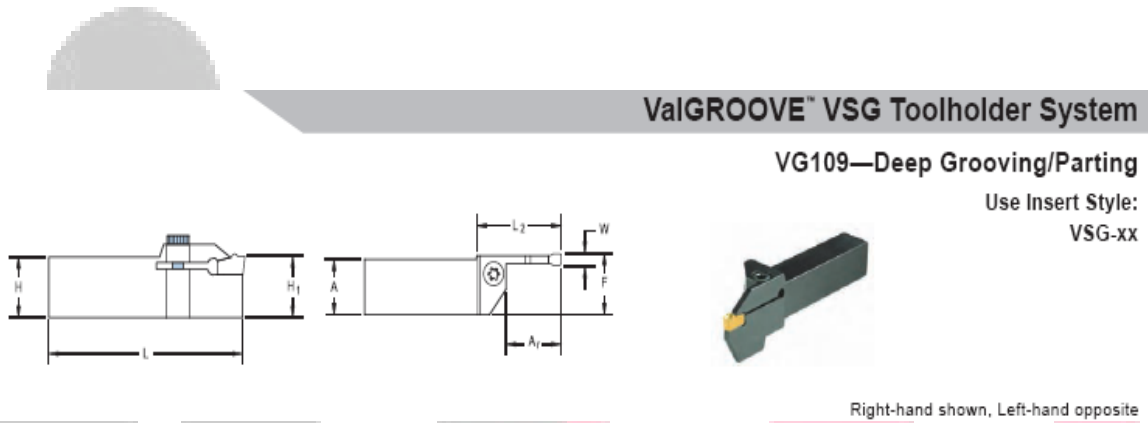

Part Number	Dimensions								
	Seat Size	Seat Width	W	A	F	H	H1	L	L2
VG109 R 12 30	30	0.093	.118-.163	0.75	1	0.75	0.75	5	1.614
VSG30N30	INSERT	INSERT	0.125						



Tool # 8

Parting Tool

DGFH 26-3

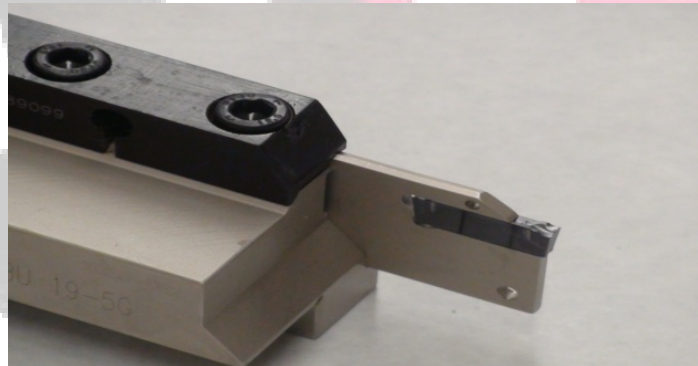
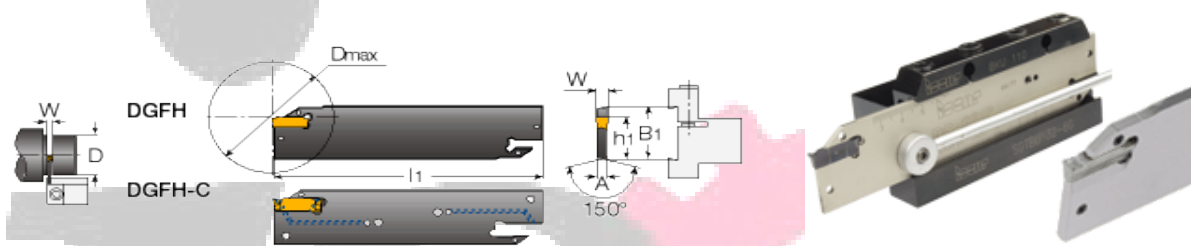

Part Number	Dimensions						
	B1	W min	W max	A	l1	h1	D max
DGFH 26-3	1.024	0.039	0.125	0.094	4.331	0.843	1.535
DGN3102/IC354	INS	INSERT	0.122				

